

Istruzioni di Montaggio

Assembly Instructions

Instructions de Montage

Montageanleitung

Instrucciones de Montaje

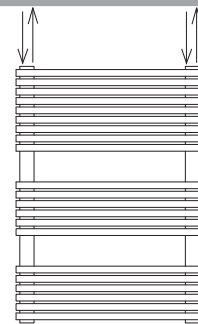

NO

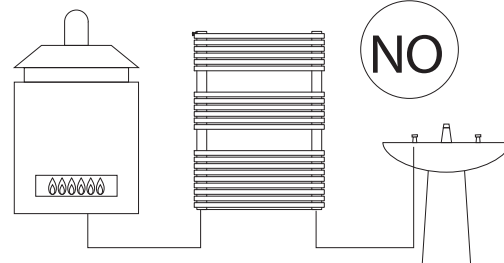
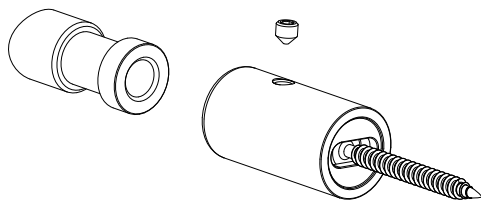
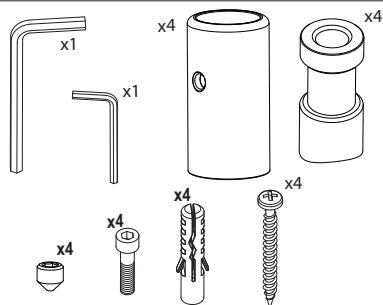

NO

- I sistemi di fissaggio (viti + tasselli) sono idonei per impiego su pareti compatte o in laterizio forato. Per pareti in materiali diversi è responsabilità dell'installatore adottare sistemi di fissaggio appropriati.
- The fixing kits (screws and dowels) are suitable for compact wall or hollow bricks. For wall in different materials it is responsibility of the installer to use appropriate fixing.
- Les systèmes de fixation (vis + chevilles) sont aptes à être utilisés sur des parois compactes ou en briques creuses. Pour des parois avec des matériaux différents, la responsabilité sera de l'installateur qui devra utiliser des systèmes de fixation appropriés.
- Die Verbindungselemente (Schrauben + Dübel) sind für den Einsatz in kompakten oder hohlen Ziegelmauern. Bei Einsatz in unterschiedliche Materialien liegt in der Verantwortung des Installateurs geeignete Verbindungselemente einzusetzen.
- Los sistemas de fijación (tornillos + tacos) son adecuados para uso en paredes compactas o de ladrillo hueco. Para paredes de material diferente el instalador debe adoptar los sistemas de fijación pertinentes.

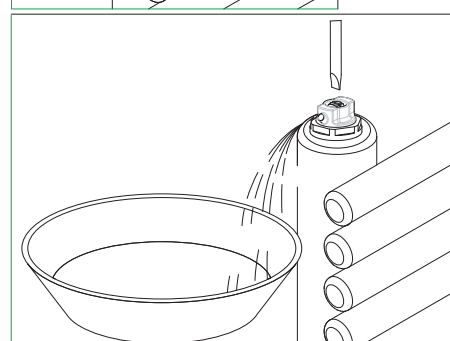
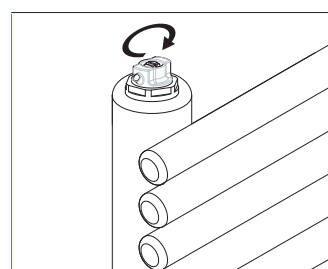
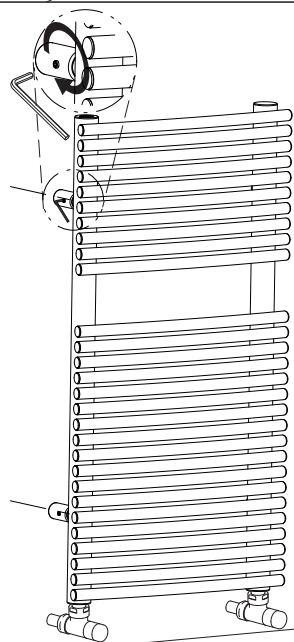
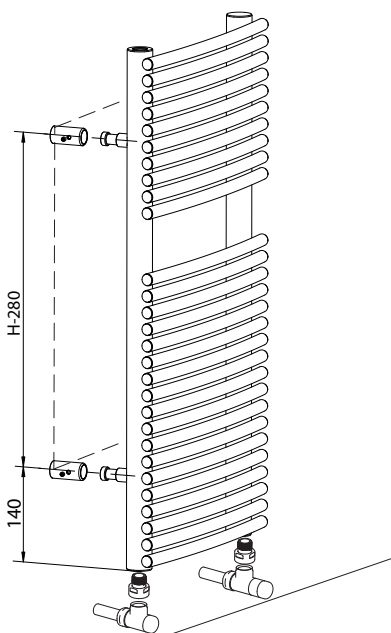
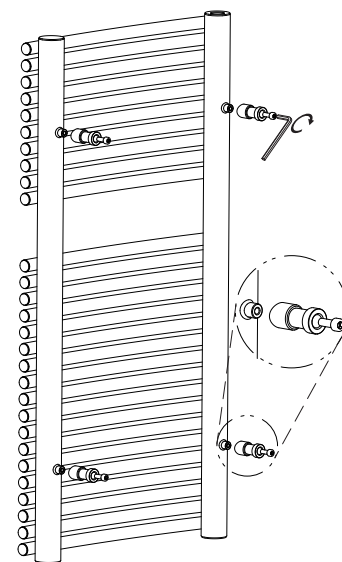
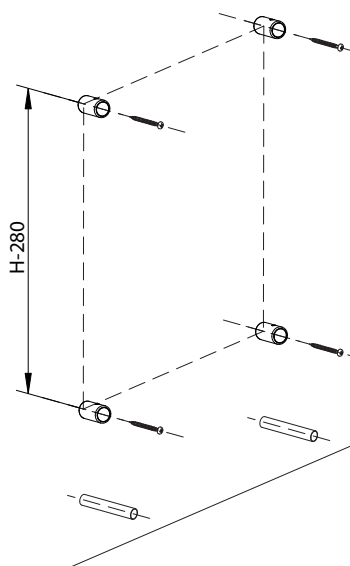
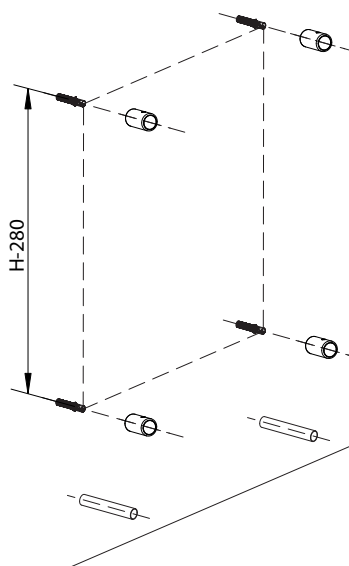
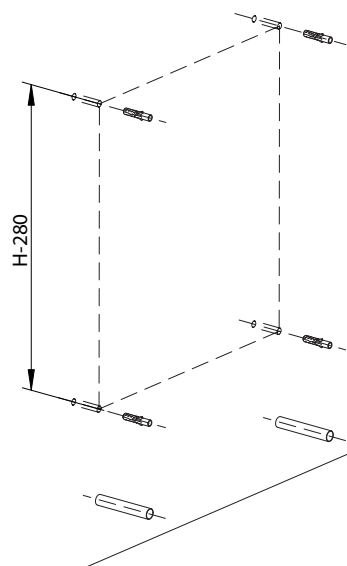

Instrucțiuni de Montaj

Návod na montáž

Instrukcje montażu

Инструкции по монтажу

Pokyny k montáži

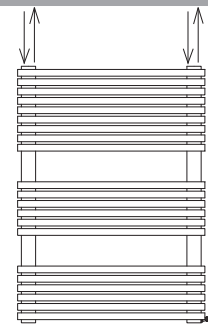

NO

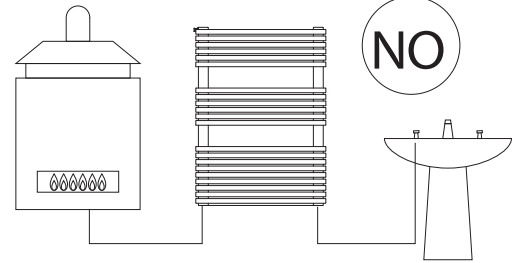
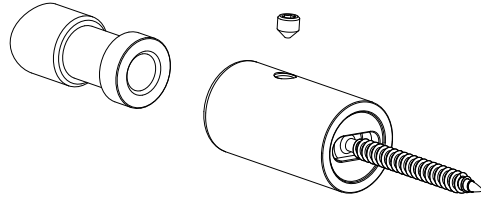
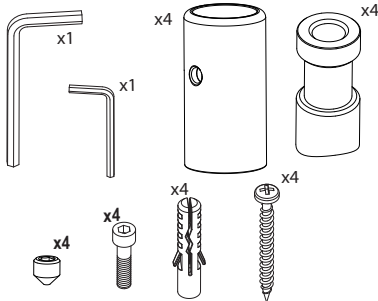

NO

- Sisteme de fixare (șuruburi + dibluri) sunt adecvate pentru folosirea pe pereți compacți sau din cărămizi goale. Pentru pereți din materiale diverse este de responsabilitatea instalatorului să adopte sisteme de fixare adecvate.
- Uchycovací systémy (šrouby + hmoždinky) jsou vhodné pro použití na plných stěnách nebo na děrovaných cihlách. U stěn z jiných materiálů instalatér nese odpovědnost za zvolení vhodných uchycovacích systémů.
- Systemy mocowania (śruby + kołki) nadają się do stosowania w ścianach z cegły lub z pustaków. W przypadku ścian wykonanych z innych materiałów, obowiązkiem instalatora jest dobrać odpowiednich systemów mocowania.
- Крепежные элементы (винты+дюбеля) предназначены для использования на компактных стенах или перфорированном кирпиче. Для стен, изготовленных из другого материала, монтажник должен использовать соответствующие крепежные элементы.
- Spojovací materiál (skrutky + klíny) je vhodný pre použitie u kompaktných alebo dutých tehlových stien. V prípade stien z iných materiálov je na zodpovednosti inštalátora, aby zvolil najvhodnejší spojovací materiál.

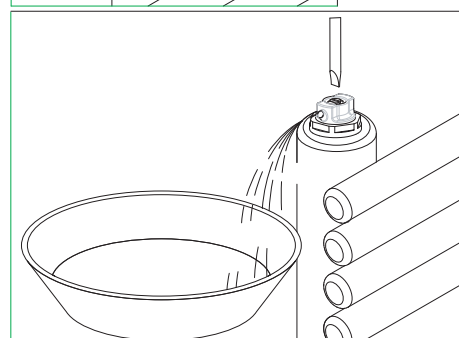
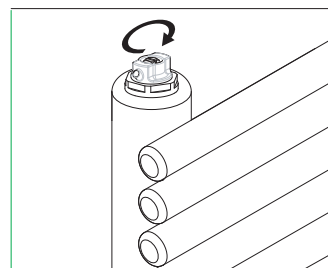
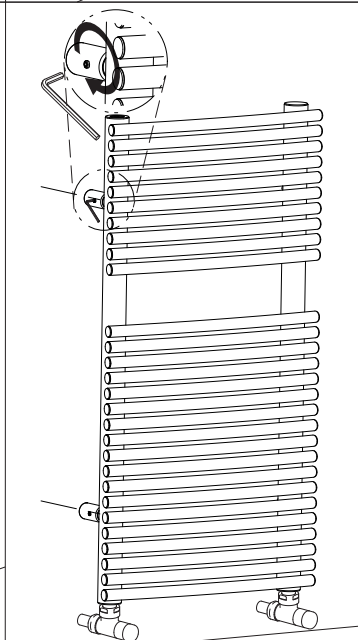
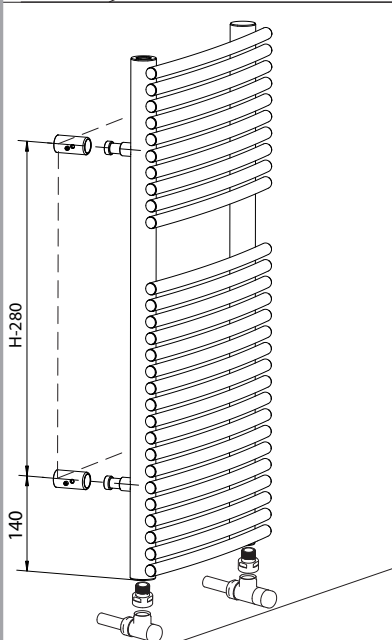
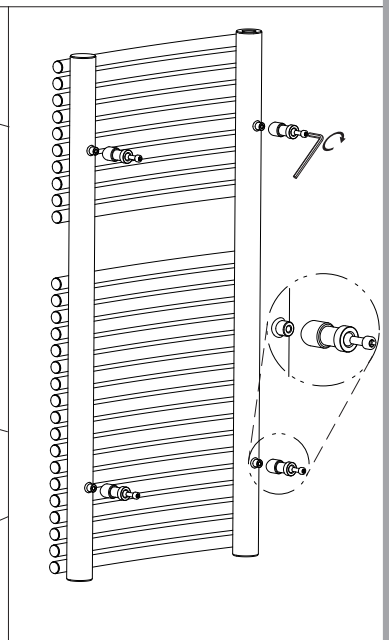
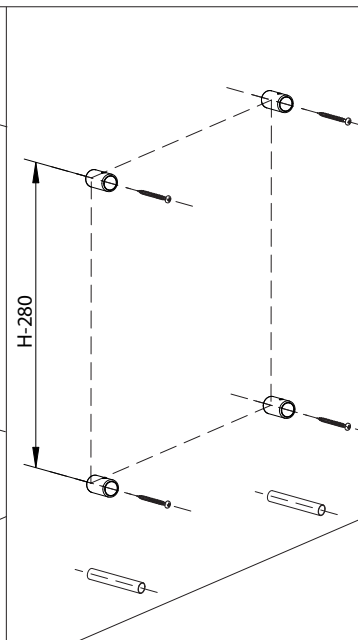
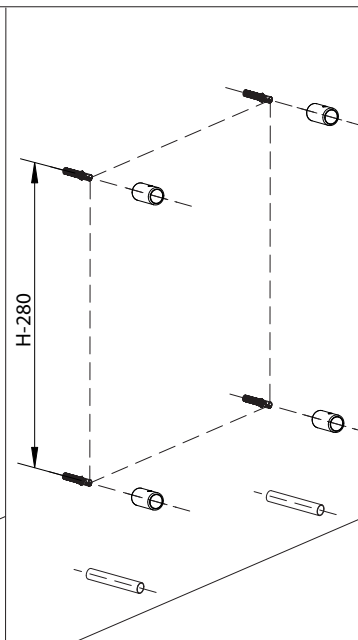
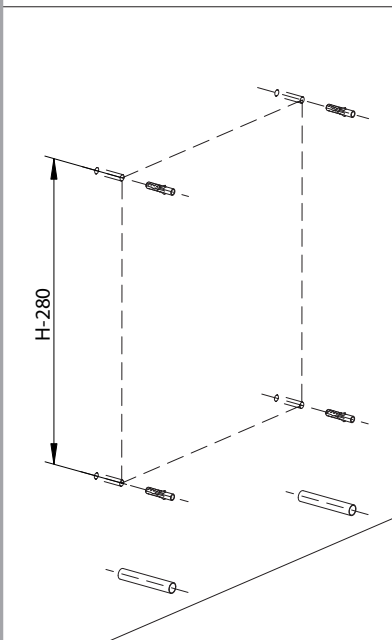

Istruzioni di Montaggio

Assembly Instructions

Instructions de Montage

Montageanleitung

Instrucciones de Montaje

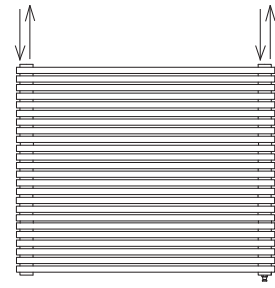

NO

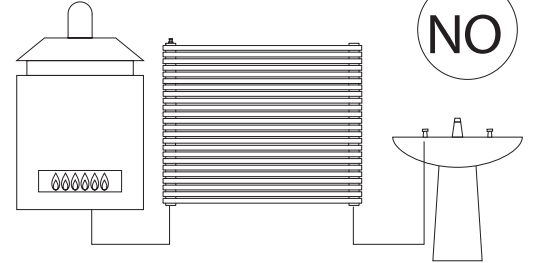
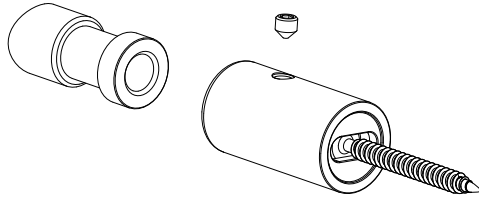
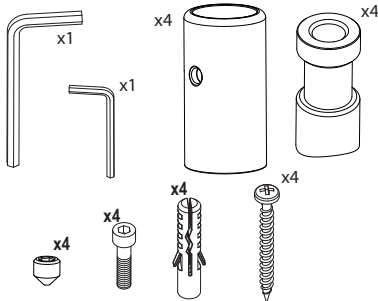

NO

- I sistemi di fissaggio (viti + tasselli) sono idonei per impiego su pareti compatte o in laterizio forato. Per pareti in materiali diversi è responsabilità dell'installatore adottare sistemi di fissaggio appropriati.
- The fixing kits (screws and dowels) are suitable for compact wall or hollow bricks. For wall in different materials it is responsibility of the installer to use appropriate fixing.
- Les systèmes de fixation (vis + chevilles) sont aptes à être utilisés sur des parois compactes ou en briques creuses. Pour des parois avec des matériaux différents, la responsabilité sera de l'installateur qui devra utiliser des systèmes de fixation appropriés.
- Die Verbindungselemente (Schrauben + Dübel) sind für den Einsatz in kompakten oder hohlen Ziegelmauern. Bei Einsatz in unterschiedliche Materialien liegt in der Verantwortung des Installateurs geeignete Verbindungselemente einzusetzen.
- Los sistemas de fijación (tornillos + tacos) son adecuados para uso en paredes compactas o de ladrillo hueco. Para paredes de material diferente el instalador debe adoptar los sistemas de fijación pertinentes.

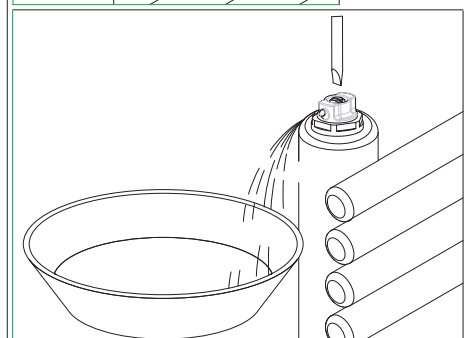
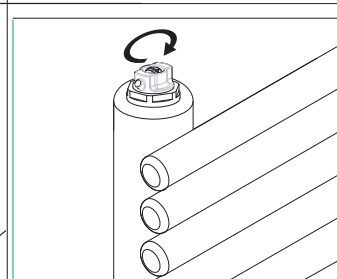
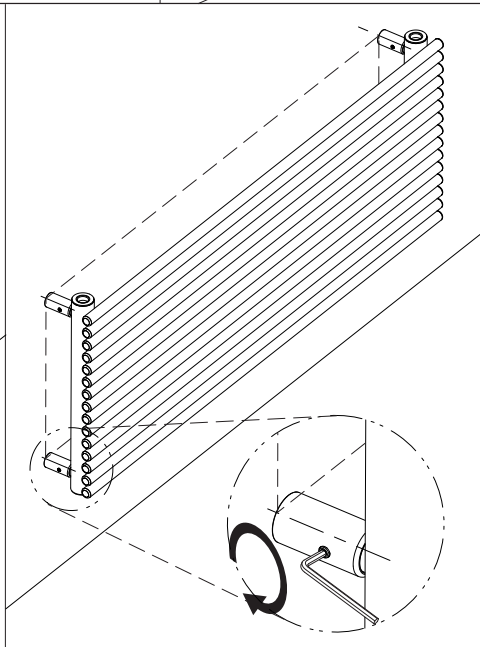
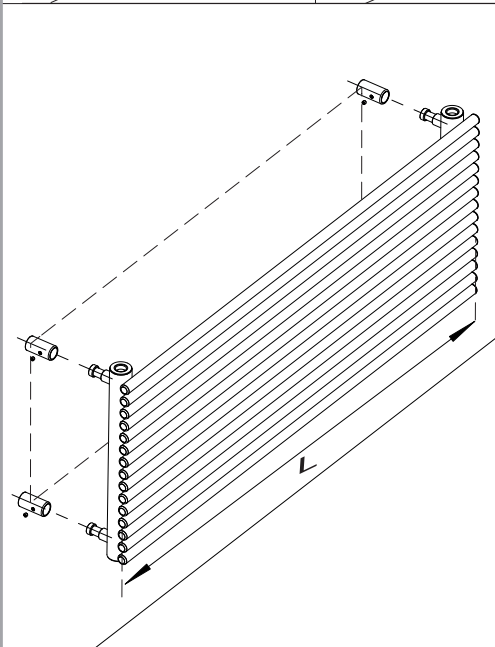
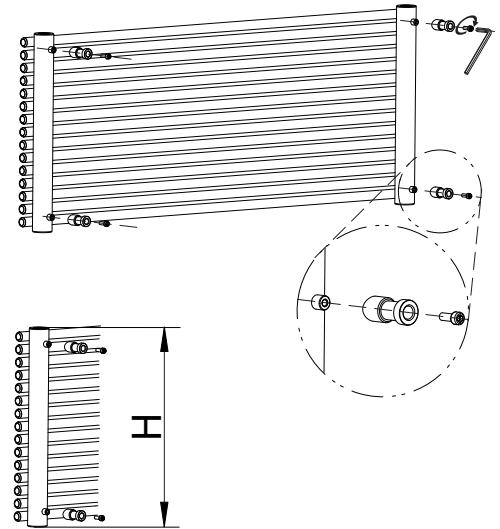
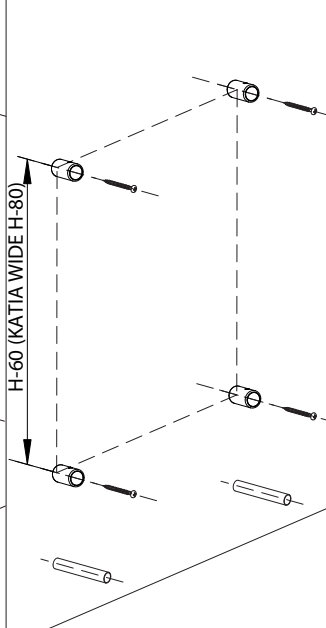
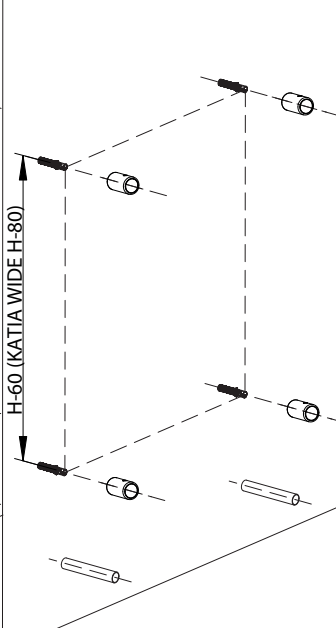
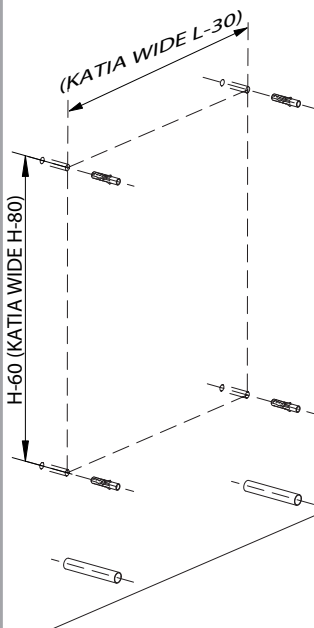

Instrucțiuni de Montaj

Návod na montáž

Instrukcje montażu

Инструкции по монтажу

Pokyny k montáži

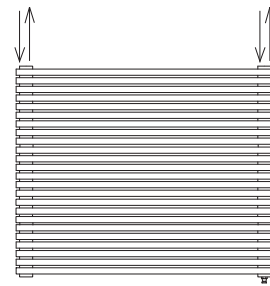

NO

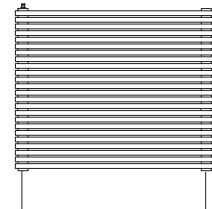
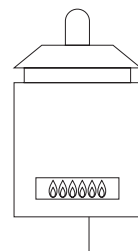
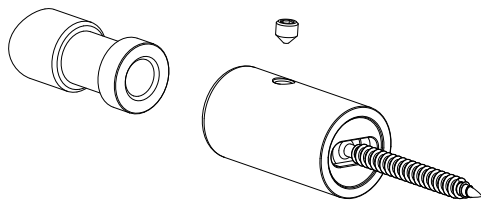
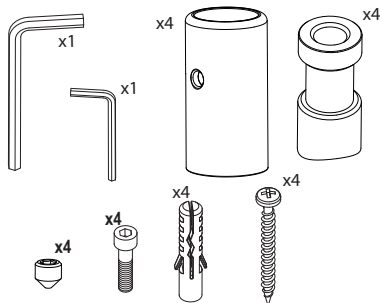

NO

- Sistemele de fixare (șuruburi + dibluri) sunt adecvate pentru folosirea pe pereți compacți sau din cărămizi goale. Pentru pereți din materiale diverse este de responsabilitatea instalatorului să adopte sisteme de fixare adecvate.
- Uchycovací systémy (šrouby + hmoždinky) jsou vhodné pro použití na plných stěnách nebo na děrovaných cihlách. U stěn z jiných materiálů instalatér nese odpovědnost za zvolení vhodných uchycovacích systémů.
- Systemy mocowania (śruby + kołki) nadają się do stosowania w ścianach z cegły lub z pustaków. W przypadku ścian wykonanych z innych materiałów, obowiązkiem instalatora jest dobranie odpowiednich systemów mocowania.
- Крепежные элементы (винты+дюбеля) предназначены для использования на компактных стенах или перфорированном кирпиче. Для стен, изготовленных из другого материала, монтажник должен использовать соответствующие крепежные элементы.
- Spojovací materiál (skrutky + kliny) je vhodný pre použitie u kompaktných alebo dutých tehlových stien. V prípade stien z iných materiálov je na zodpovednosti inštalátora, aby zvolil najvhodnejší spojovací materiál.

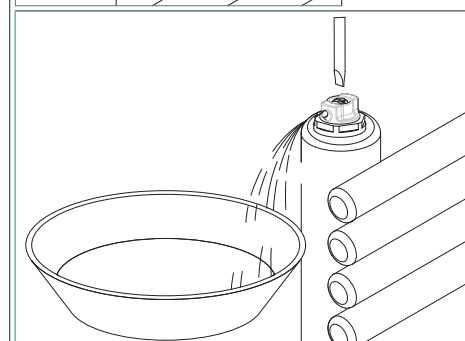
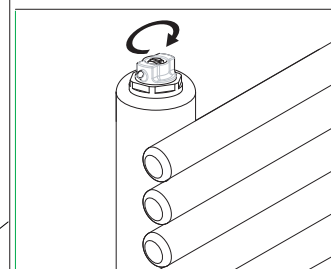
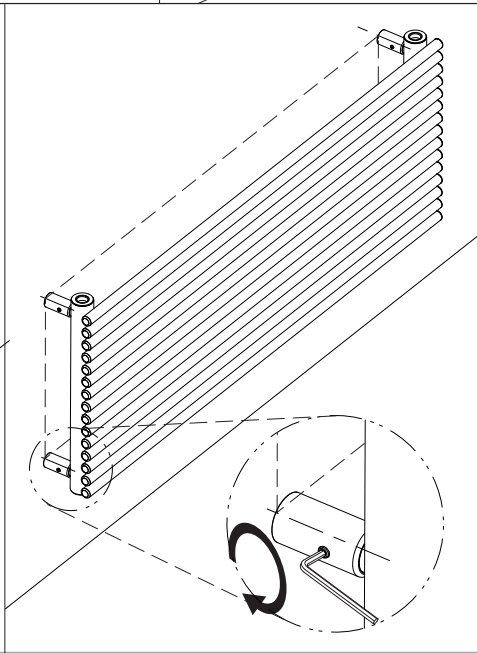
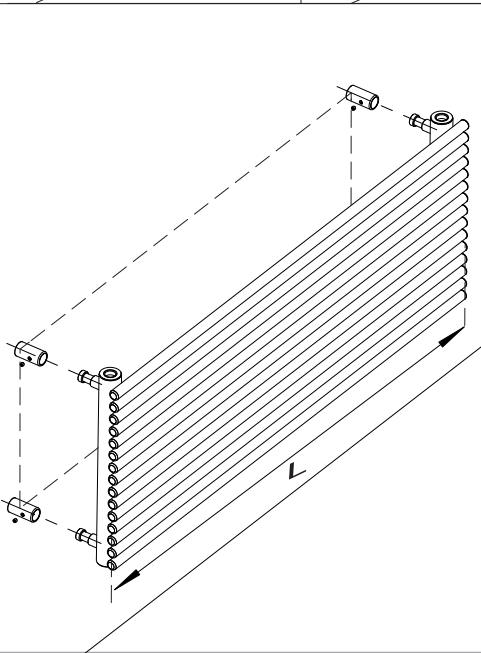
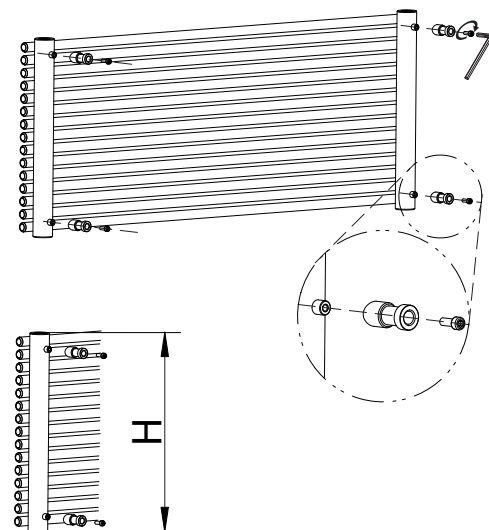
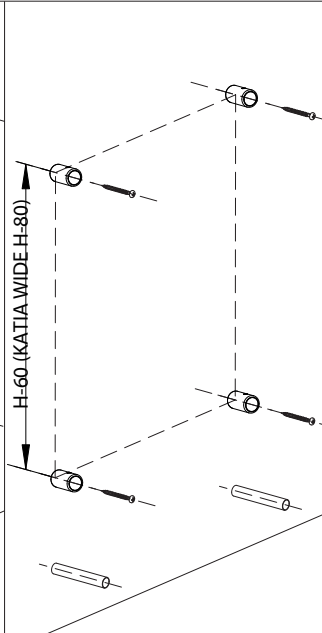
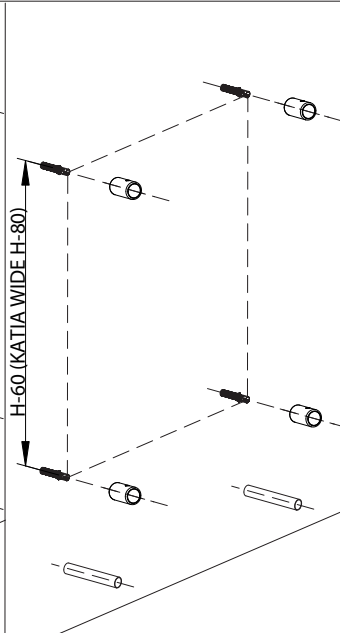
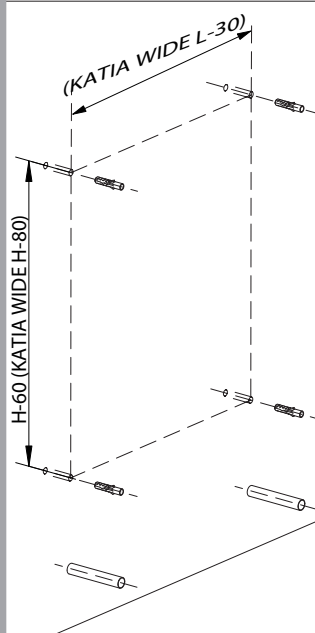

Istruzioni di Montaggio

Assembly Instructions

Instructions de Montage

Montageanleitung

Instrucciones de Montaje

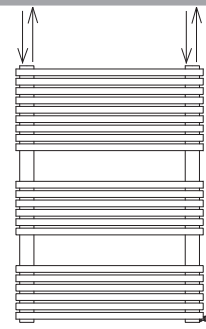

NO

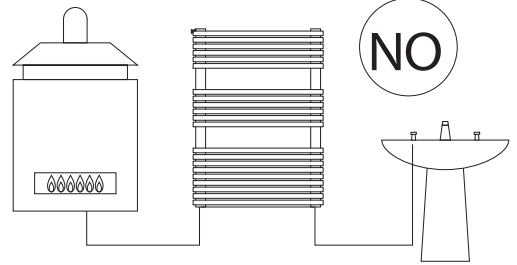
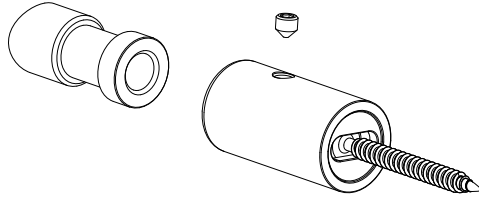
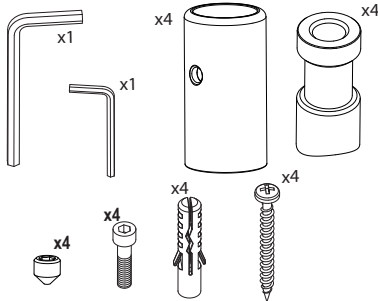

NO

- I sistemi di fissaggio (viti + tasselli) sono idonei per impiego su pareti compatte o in laterizio forato. Per pareti in materiali diversi è responsabilità dell'installatore adottare sistemi di fissaggio appropriati.
- The fixing kits (screws and dowels) are suitable for compact wall or hollow bricks. For wall in different materials it is responsibility of the installer to use appropriate fixing.
- Les systèmes de fixation (vis + chevilles) sont aptes à être utilisés sur des parois compactes ou en briques creuses. Pour des parois avec des matériaux différents, la responsabilité sera de l'installateur qui devra utiliser des systèmes de fixation appropriés.
- Die Verbindungselemente (Schrauben + Dübel) sind für den Einsatz in kompakten oder hohlen Ziegelmauern. Bei Einsatz in unterschiedliche Materialien liegt in der Verantwortung des Installateurs geeignete Verbindungselemente einzusetzen.
- Los sistemas de fijación (tornillos + tacos) son adecuados para uso en paredes compactas o de ladrillo hueco. Para paredes de material diferente el instalador debe adoptar los sistemas de fijación pertinentes.

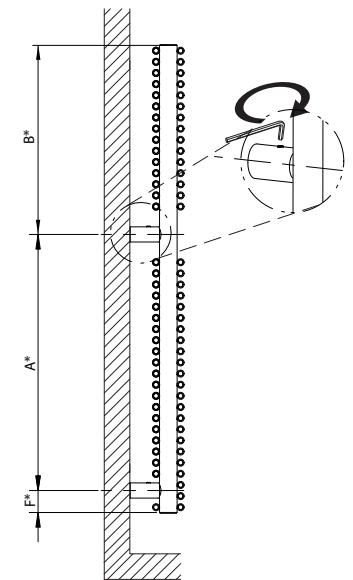
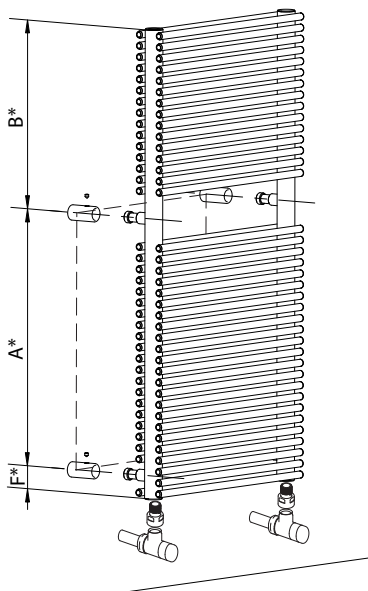
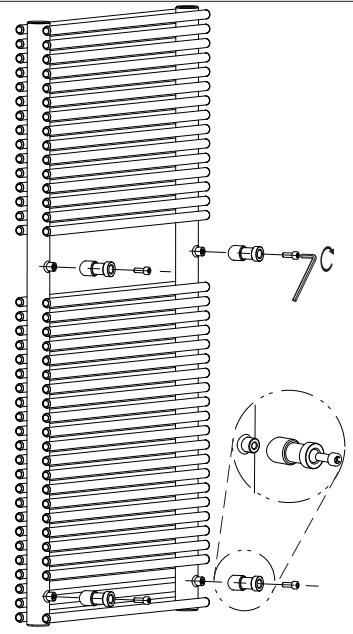
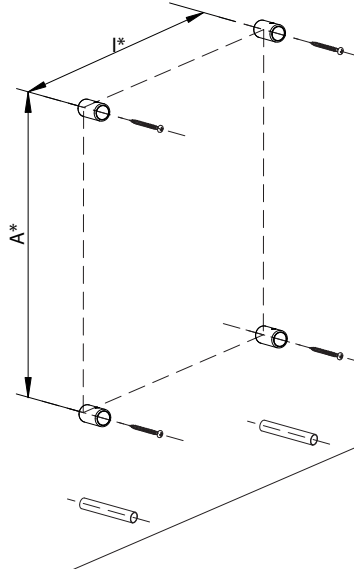
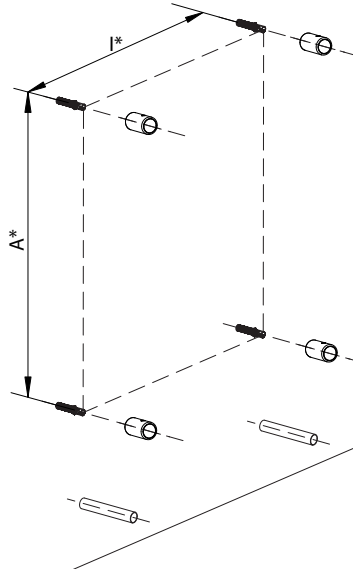
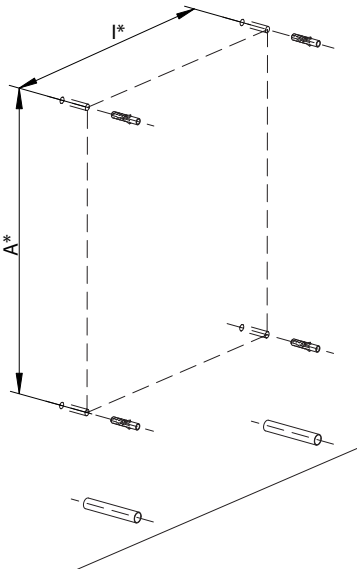

* Per le varianti vedi tab. dietro

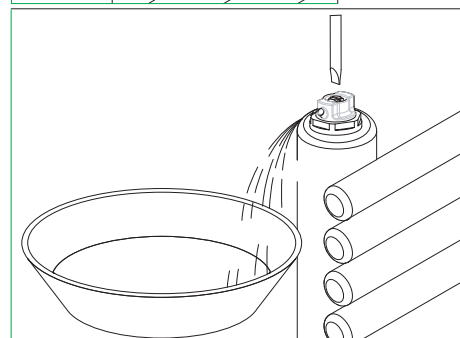
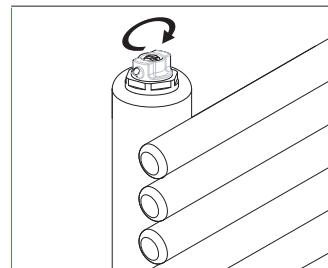

Istruzioni di Montaggio

Assembly Instructions

Instructions de Montage

Montageanleitung

Instrucciones de Montaje

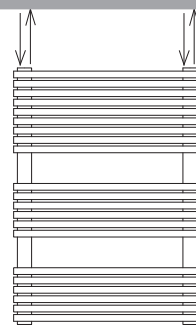

NO

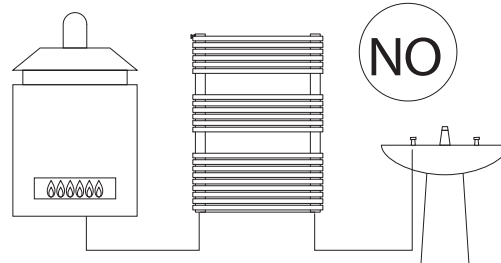
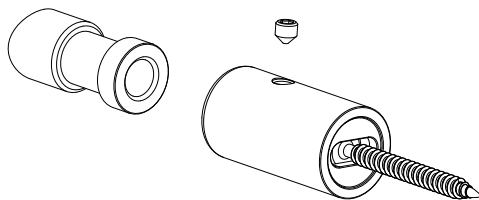
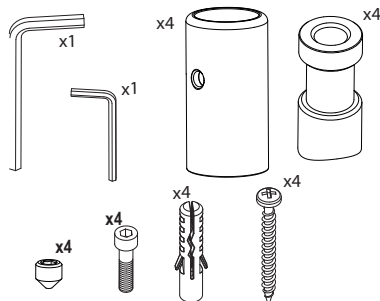

NO

- I sistemi di fissaggio (viti + tasselli) sono idonei per impiego su pareti compatte o in laterizio forato. Per pareti in materiali diversi è responsabilità dell'installatore adottare sistemi di fissaggio appropriati.
- The fixing kits (screws and dowels) are suitable for compact wall or hollow bricks. For wall in different materials it is responsibility of the installer to use appropriate fixing.
- Les systèmes de fixation (vis + chevilles) sont aptes à être utilisés sur des parois compactes ou en briques creuses. Pour des parois avec des matériaux différents, la responsabilité sera de l'installateur qui devra utiliser des systèmes de fixation appropriés.
- Die Verbindungselemente (Schrauben + Dübel) sind für den Einsatz in kompakten oder hohlen Ziegelmauern. Bei Einsatz in unterschiedliche Materialien liegt in der Verantwortung des Installateurs geeignete Verbindungselemente einzusetzen.
- Los sistemas de fijación (tornillos + tacos) son adecuados para uso en paredes compactas o de ladrillo hueco. Para paredes de material diferente el instalador debe adoptar los sistemas de fijación pertinentes.

* Vedi tabella.

Modello	H	L	I	F	B	A
Dafne_Plus	800	400	370	38	323	439
		500	470	38	323	439
	1160	400	370	474	322	364
		500	470	474	322	364
		600	570	474	322	364
	1520	400	370	474	322	724
		500	470	474	322	724
		600	570	474	322	724
	1880	400	370	473	321	1086
		500	470	473	321	1086
		600	570	473	321	1086

Modello	H	L	I	F	B	A
Lucy_Plus	760	400	342	41	316	403
		500	442	41	316	403
	1160	400	342	441	341	378
		500	442	441	341	378
		600	542	441	341	378
	1410	400	342	391	316	703
		500	442	391	316	703
		600	542	391	316	703
	1885	400	342	416	341	1128
		500	442	416	341	1128
		600	542	416	341	1128

Istruzioni di Montaggio

Assembly Instructions

Instructions de Montage

Montageanleitung

Instrucciones de Montaje

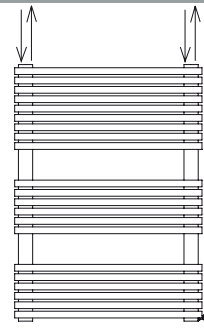

NO

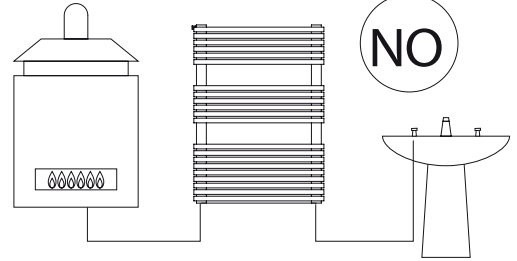
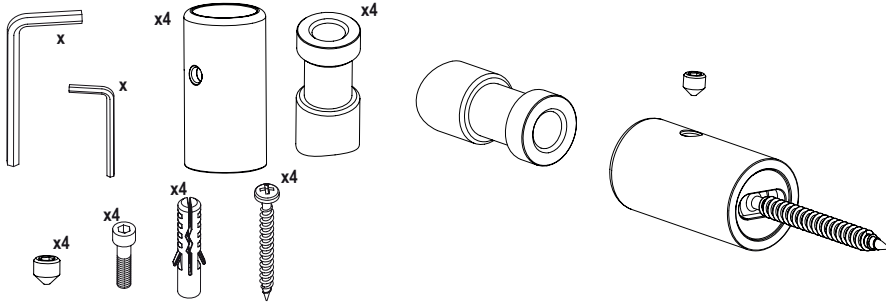

NO

- I sistemi di fissaggio (viti + tasselli) sono idonei per impiego su pareti compatte o in laterizio forato. Per pareti in materiali diversi è responsabilità dell'installatore adottare sistemi di fissaggio appropriati.
- The fixing kits (screws and dowels) are suitable for compact wall or hollow bricks. For wall in different materials it is responsibility of the installer to use appropriate fixing.
- Les systèmes de fixation (vis + chevilles) sont aptes à être utilisés sur des parois compactes ou en briques creuses. Pour des parois avec des matériaux différents, la responsabilité sera de l'installateur qui devra utiliser des systèmes de fixation appropriés.
- Die Verbindungselemente (Schrauben + Dübel) sind für den Einsatz in kompakten oder hohlen Ziegelmauern. Bei Einsatz in unterschiedliche Materialien liegt in der Verantwortung des Installateurs geeignete Verbindungselemente einzusetzen.
- Los sistemas de fijación (tornillos + tacos) son adecuados para uso en paredes compactas o de ladrillo hueco. Para paredes de material diferente el instalador debe adoptar los sistemas de fijación pertinentes.
- Системы крепления (винты + дюбели) пригодны для использования на плотных стенах или стенах из дырчатого кирпича. Для стен из других материалов выбор соответствующих систем крепления является обязанностью установщика.

